



3 391 605

3 391 622

3 391 605

3 391 606
S 3 785.5 m²

3 391 624
S 8 285.5 m²

3 391 626
S 8 877.0 m²

3 654 331

PLAN ANNEXED TO THE LOCATION CERTIFICATE

LOT 3 391 606, 3 391 624 ET 3 391 626
CADASTRE DU QUÉBEC
REGISTRATION DIVISION OF GATINEAU
MONTREAL, LA PÊCHE

LA PÊCHE (FEBRUARY 24th 2011)
FORTIN & ROBERTSON
INCORPORATED
400-500-2200
400-500-2200

SEE SUBMITTED REGULATORY WITH AND SINCE 2011
N.B. Shaded distances are measured from the exterior facing of the buildings.
Distances indicated on the document are in meters (m).

LEGEND:

- ROAD SIGN: WALKER
- POWER POLE
- POWER LANE
- LAMP POST
- STONE WALL
- FENCE
- FENCE: BLOCK SIGN
- SIGN

3 391 625

3 391 625

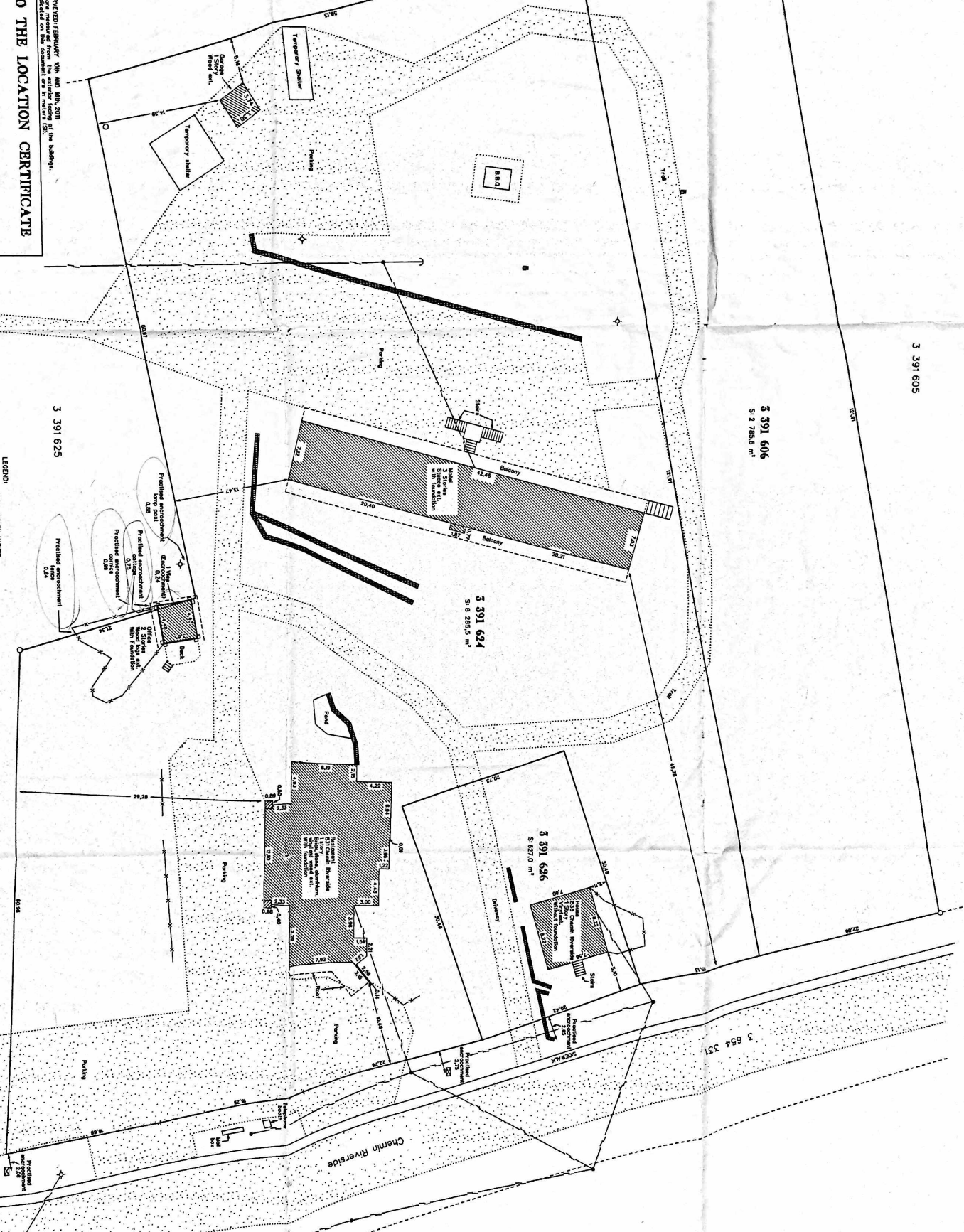

SCALE: 1:250
MONTREAL, QUÉBEC
DATE: 02/24/2011

THE COPY OF ORIGINAL BY INCLUDING FORTIN & ROBERTSON